



APPNA Alberta Chapter Welcome Brochure

Banff Centre for Arts and
Creativity, Alberta
Friday August 19 and
Saturday August 20, 2022



**APPNA Western Canada
Conference 2022** 



Hosted by APPNA Alberta Chapter



Updated April 16, 2022

Thank you for your registration to join us for this event surrounded by majestic mountains and continually reminded of nature's bountiful beauty. Our fruitful weekend will provide many opportunities to enhance your continuing professional development, network with colleagues and be a part of our celebratory events in the evening.

Travel to Banff

Travel time from the Calgary International Airport to Banff, where our event will unfold, is approximately one hour and 30 minutes and approximately 118 kilometers from the western city limits of Calgary.

Banff is a resort town in the province of Alberta, located within Banff National Park. The peaks of Mt. Rundle and Mt. Cascade, part of the Rocky Mountains, dominate its skyline. On Banff Avenue, the main thoroughfare, boutiques and restaurants mix with chateau-style hotels and souvenir shops. The surrounding 6,500 square kilometres of parkland are home to wildlife including elk and grizzly bears.

Banff National Park

Your very scenic drive towards Banff will provide a taste of picture-perfect mountains and an abundance of wildlife and little towns peppered along the way. [Banff National Park](#) is Canada's first national park and the flagship of the nation's park system with over three million visitors per year. Banff is part of the Canadian Rocky Mountain Parks and is deemed a UNESCO World Heritage Site.

Park Pass

When entering Banff National Park, a park pass is required to help support visitor services and facilities. You can either purchase a pass at the park gates or pre-purchase. [Please see their website here for rates.](#)

Things to do

Banff and the surrounding areas such as Jasper, Kananaskis, Canmore and Calgary offers many unique experiences for you and your family to enjoy. Please [visit our website](#) for ideas and registration information!

The Conference Venue

[The Banff Centre for Arts and Creativity](#) is located at 107 Tunnel Mountain Drive in Banff Alberta, and if you need to reach the hotel reception, they can be reached at 403.762.6100.

This very dynamic venue's mission to bring together artists, leaders, and communities together to create, collaborate, share, envision, learn, and be inspired which is a wonderful fit for the objectives of our weekend together.

Accommodation Reservations

Please contact the hotel to make a reservation at 1.800.884.7574 prior to **Wednesday July 20, 2022** to take advantage of our event rates. Please mention you are part of our conference. Please note there is a facility fee of \$15 per room per day that includes parking, WiFi, access to the recreational centre, parking, and the site library. For more information, please [access this link](#).

The Main Event

All of the event activities will be held in the [Kinneer Centre for Creativity & Innovation](#), Room 101 & Room 103, and the exhibitor area will be located in Room 105, all on the main level.

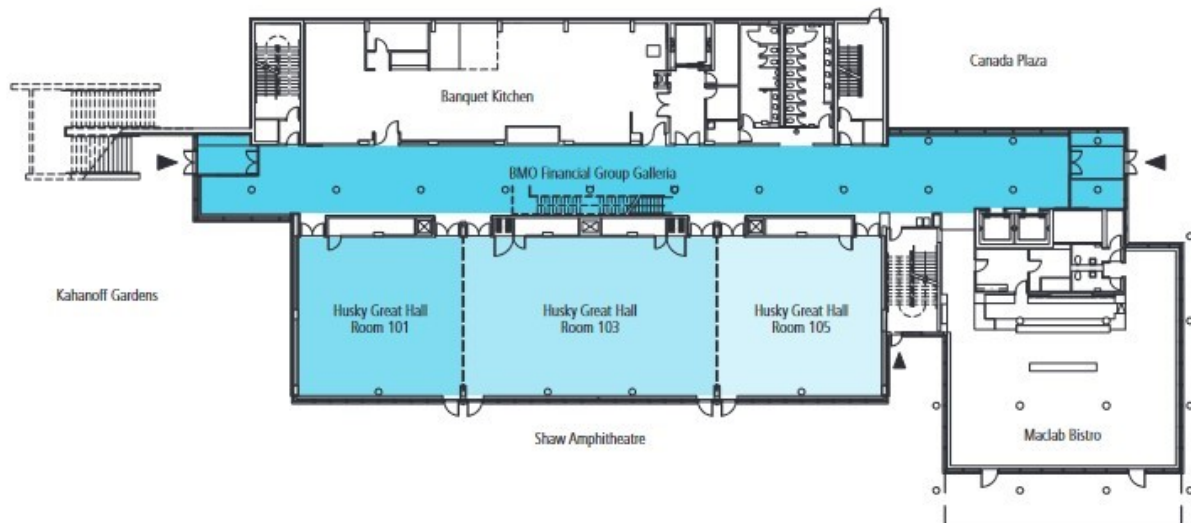

In the coming months, all participants will receive multiple emails with additional logistics and information to prepare them well for our event.

Upon Arrival to the Conference Area

Upon arrival to the Kinnear Centre, you will be required to obtain your conference packet and complete a brief registration process. You will receive a conference brochure and a name lanyard that **must be worn at all times**. We will do our best to expedite this process for you so you can find a seat in the main hall that best suits you. If you have any questions, please connect with the Event Manager who will be visible and on site throughout our event.

Celebratory Dinners on Friday and Saturday Evening

Tickets are available for the celebratory dinners occurring each evening which will also include live entertainment for you and your family. More information is forthcoming! Don't forget to purchase your tickets!

Covid Protocols

Coronavirus protocols will be implemented throughout the meeting for all exhibitors/attendees in accordance with guidelines recommended by the federal, province and local health officials and the APPNA Western Canada Conference host committee. AWCC 2022 reserves the right to determine whether ANY person in attendance should be isolated/evacuated from the event site that is deemed to be in violation of COVID guidelines. We strongly recommend that you do not attend in person if you have not completed the COVID19 vaccination and/or are at an elevated risk for COVID19 infection.

A face mask will be required while at the event. We will continue to monitor situation and relax restrictions according to federal, provincial and local guidelines.

If you have any additional questions in the interim, please email us at info@appnaalberta.ca